

FRENCH VALLEY BUSINESS PARK

Russell Springs, Kentucky

The development was designed with the open ended needs of today's industries in mind. It is a 104.2 acre park located 2.5 miles from the Cumberland Parkway, north via U.S. Hwy. 127. This site features 8" sewer and 4" gas lines.

Below is a surveyed layout of the park with speculative building and parking. Currently all lots are still available.

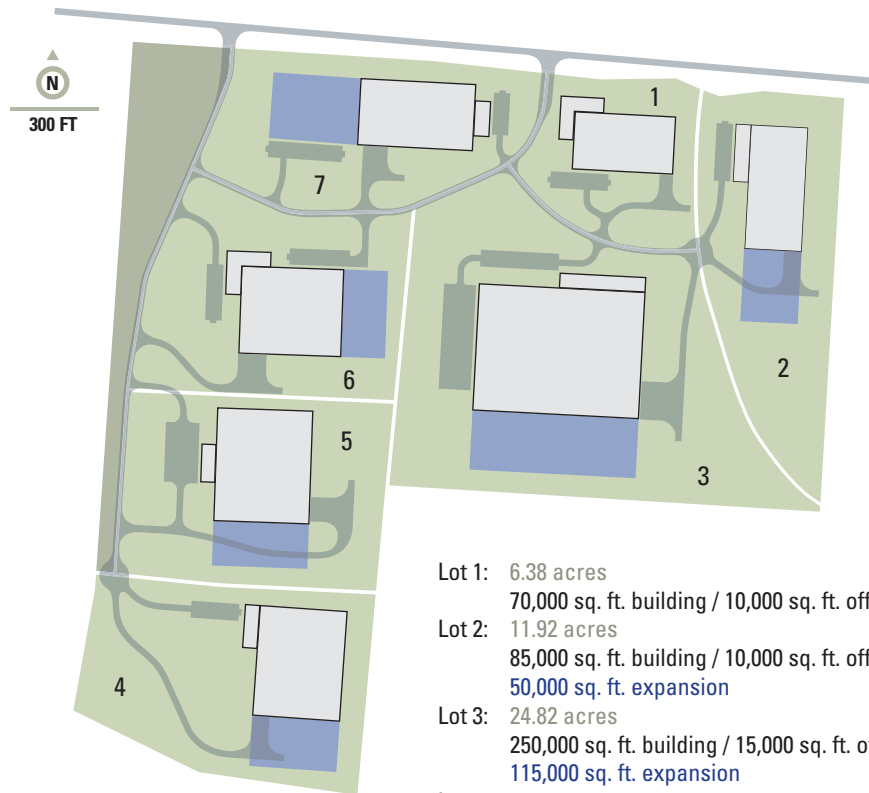

- Lot 1: 6.38 acres
70,000 sq. ft. building / 10,000 sq. ft. office
- Lot 2: 11.92 acres
85,000 sq. ft. building / 10,000 sq. ft. office
50,000 sq. ft. expansion
- Lot 3: 24.82 acres
250,000 sq. ft. building / 15,000 sq. ft. office
115,000 sq. ft. expansion
- Lot 4: 13.95 acres
112,500 sq. ft. building / 7,500 sq. ft. office
52,500 sq. ft. expansion
- Lot 5: 12.93 acres
125,000 sq. ft. building / 6,500 sq. ft. office
48,750 sq. ft. expansion
- Lot 6: 12.41 acres
105,000 sq. ft. building / 12,500 sq. ft. office
45,000 sq. ft. expansion
- Lot 7: 10.76 acres
90,000 sq. ft. building / 6,000 sq. ft. office
90,000 sq. ft. expansion



Russell County Industrial
Development Authority

2150 N. Main Street,
Jamestown, Kentucky 42629
(270) 866-7070
www.rcidaky.com

FRENCH VALLEY BUSINESS PARK

Russell Springs, Kentucky

Location: Partially within western city limits of Russell Springs.

Zoning: I-1 Light Industrial

Highway Access: Louise B. Nunn Parkway interchange approximately 2.0 miles north via US 127

Commercial Air Access: Blue Grass Airport (Lexington, Ky.) Distance: 92 miles northeast of site

Railroad: Not rail served

Water: Russell Springs Water & Sewer
8" line serves the site

Sewer: City of Russell Springs
8" gravity line serves the site

Natural Gas: Lake Cumberland Gas Authority
4" line serves the site

Electricity: LG&E Energy Corp. (KU); South Kentucky RECC

Broadband (type/service): ILEC: Duo County Telephone Cooperative Corporation Inc.

Flood Data: Not in 100-year flood plain

Ownership: Russell County Industrial Development Authority

School District: Russell County

For further information contact:
Greg Jones, Executive Director
Russell County Industrial Development Authority
2150 N. Main Street, Jamestown, Kentucky 42629
(270) 866-7070



Russell County Industrial
Development Authority

2150 N. Main Street,
Jamestown, Kentucky 42629
(270) 866-7070
www.rcidaky.com